



Dorset Road, Coventry, CV1 4ED



# Property Description

Loveitts welcome to the market this opportunity to acquire this two bedroom mid-terraced property situated within walking distance to Coventry City Centre. It is an ideal purchase for a first time buyer or property investor and is offered for sale with no onward chain.

The accommodation on offer briefly comprises lounge, separate dining room, fitted kitchen, two double bedrooms and a ground floor family bathroom with bath and over shower. The property also benefits from a secure rear garden.

Call us now to arrange a viewing.







**Ground Floor**  
Approx. 43.8 sq. metres (471.6 sq. feet)

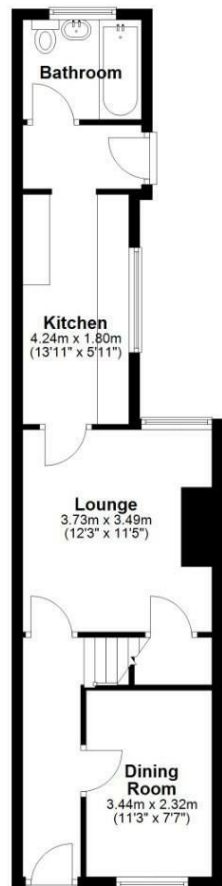

**First Floor**  
Approx. 28.8 sq. metres (309.8 sq. feet)

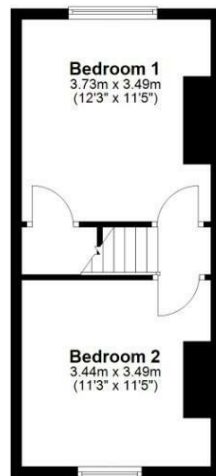

Total area: approx. 72.6 sq. metres (781.4 sq. feet)

All efforts have been made to ensure that the measurements on this floorplan are accurate however these are for guidance purposes only.  
Plan produced using PlanUp.

## Key Features

- Two Bedroom Property
- Two Reception Rooms
- Close to the City Centre
- Double glazed and Gas central heated
- No upward chain
- Ideal Rental Investment or First time purchase
- Call now to arrange a viewing
- EPC - D

**£150,000**

EPC Rating - D

Tenure - Freehold

Council Tax Band - A

Local Authority -  
CCC

We routinely refer clients to both our recommended Legal Firm and a panel of Financial Services Providers. It is your decision whether you choose to deal with these companies. In making that decision, you should know that we receive a referral fee